

verify all dimensions on site prior to commencement of work figured dimensions to be taken in preference to scaling			
amendments		by	date
A	ISSUE FOR PRE-DA	LS	22.07.13
B	PLAN REVISED	LS	29.07.13
C	PLAN REVISED	LS	05.08.13
D	PLAN REVISED	DS	09.08.13

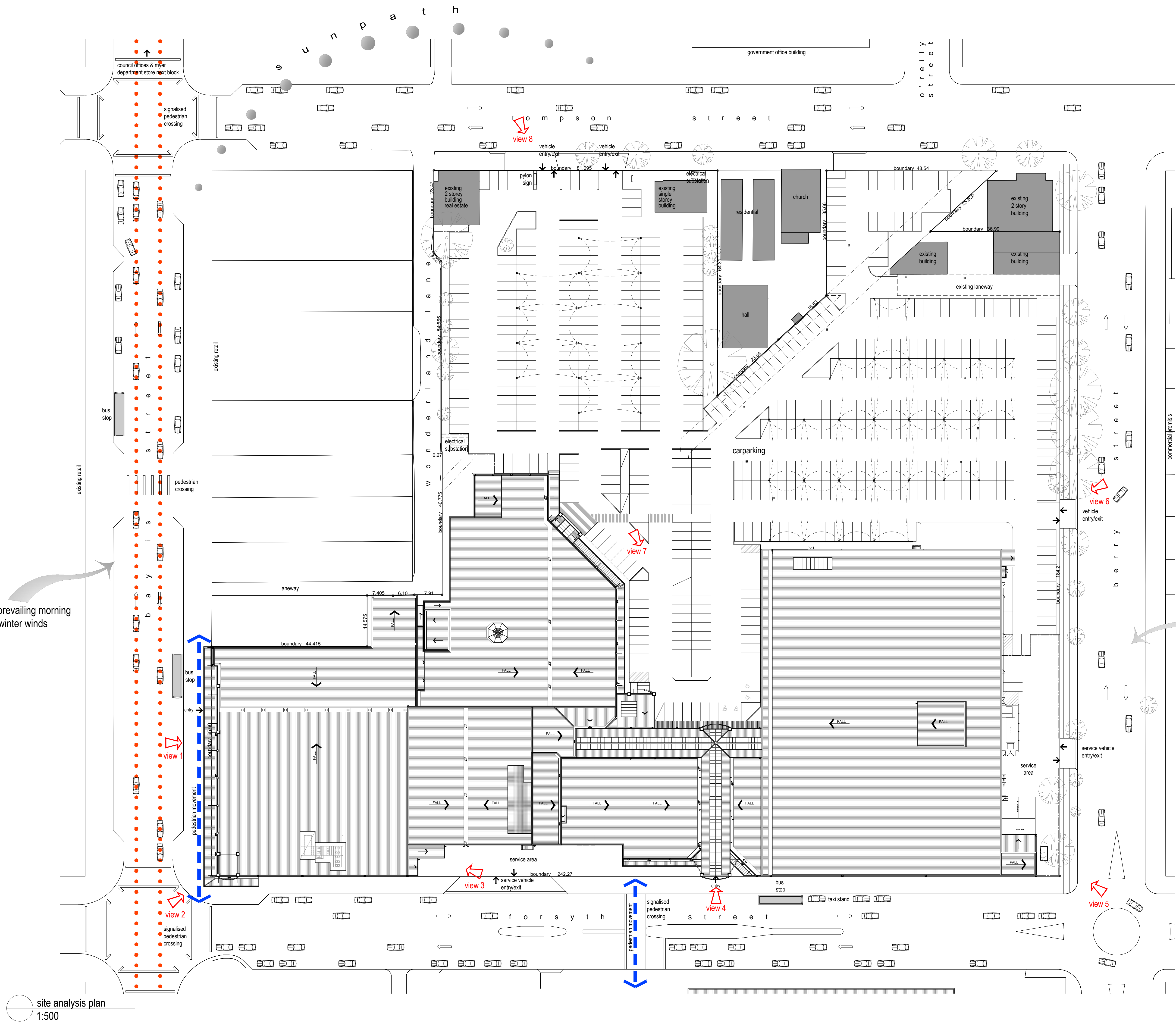

site photo - view 8  
tompson street



site photo - view 7  
carpark & entry statement



site photo - view 6  
berry street & carpark entry



site photo - view 5  
cnr forsyth & berry street



location plan  
nts



locality plan  
nts

notes:  
this drawing has been prepared utilising survey information  
provided by esler & associates - job reference.: 70558  
dated 12 06 13 with ahd datum.

please read in conjunction with survey drawing for  
information defining boundary extents, location of  
services, characteristics of existing development etc.

refer to hydraulic engineers drawings for proposed  
stormwater concept.

bus routes: ● ● ● ●	
960	lake albert
962	bourke lands
964	glenfield park
961	glenfield park
963	estrella
965	forest hill



site photo - view 1  
bayliss street



site photo - view 2  
cnr bayliss & forsyth street



site photo - view 3  
forsyth street loading dock



site photo - view 4  
forsyth street

# SITE ANALYSIS PLAN PROPOSED ALTERATIONS + ADDITIONS STURT MALL SHOPPING CENTRE TOMPSON, BERRY, FORSYTH + BAYLISS STREETS WAGGA WAGGA, NSW FOR LOCAL GOVERNMENT SUPERANNUATION 08046 DA1.01D

